

# Chockfast®



## CHOCKFAST® BLACK – PREMIUM TWO-COMPONENT EPOXY CHOCKING COMPOUND

TECHNICAL DATA SHEET #666

REVISED: 10/2023

VERSION: K

### PRODUCT DESCRIPTION

CHOCKFAST Black is a specifically formulated 100% solids, inert filled casting compound developed for use as a chocking material. It is a cost-effective method of maintaining permanent precise alignment of critical equipment. It will withstand severe environments involving high physical and thermal shock.

### USE & BENEFITS

This unique product is used under gas and diesel engines, compressors, generators, turbines, motors, pumps, and various other types of equipment. CHOCKFAST Black is ideal for use under these hot running reciprocating and rotating machines because of its excellent resistance to creep and fatigue at high operating temperatures. It is non-shrinking and has a very high impact and compressive strength. Resin chocks made with CHOCKFAST Black reduce possible bearing or crankshaft damage because they (1) minimize heat build-up on foundations, (2) assure precise alignment and unsurpassed contact with bedplates, and (3) provide a high coefficient of friction to help hold engines down tight. The excellent fluidity of CHOCKFAST Black allows it to fill voids in the chock area and conform to all surface irregularities.

### DESIGN CONSIDERATIONS

CHOCKFAST Black was designed to be a thick pour liquid chocking material. A chock depth of 2" (50-mm) is standard; however, thinner, or thicker pours can be made satisfactorily. The 2" (50-mm) chock elevates equipment above the underlying foundation, which allows a free flow of

air thereby reducing possible foundation humping problems.

Please contact your local representative of our Worldwide Distributor Network or ITW Performance Polymers for information regarding pours less than 1-1/4" (32-mm) in thickness or greater than 2-1/2" (62-mm) in thickness. Please refer to Technical Guide 692 for further recommendations and guidance on evaluating static load.

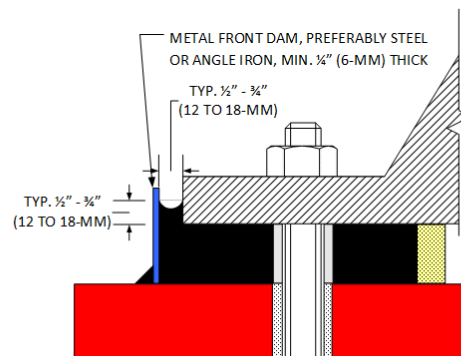
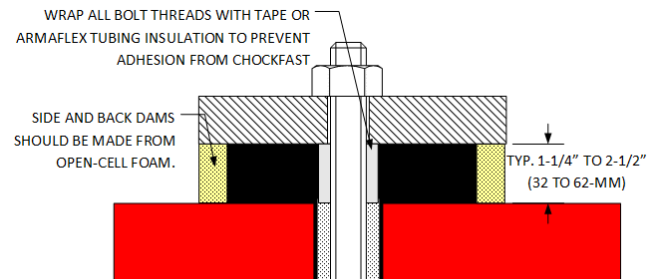

## INSTALLATION INSTRUCTIONS

Please refer to the appropriate safety data sheet (SDS) prior to using this product.

Construct a chock mold around one or more anchor bolts using open cell foam damming material on three sides.

Wrap the shank of the anchor bolt with tape, cover with foam pipe insulation or coat with non-melt grease to prevent the CHOCKFAST from sticking to it and to seal the bolt hole.

Place a metal dam 1/2" to 3/4" (12-mm to 18-mm) from the mounting pad and seal with caulk. Spray the inside of the mold and front metal dam with Release Agent.

To facilitate mixing and pouring, pre-condition CHOCKFAST

Black such that it is within an ideal temperature of 68° to 77°F (20° to 25°C) at least 24 hours prior to intending to mix and install. Mix and pour the epoxy as directed.

Refer to Technical Guides 612 and 694 for additional recommendations on damming, mixing and pouring.

**NOTE** - Do not scrape epoxy from the sides or bottom of the container when pouring.

## STORAGE RECOMMENDATIONS

All product components should be stored in a dry, shaded area in original unopened containers and within a temperature range of 65°- 95°F (16° - 35°C). For additional information, please refer to Technical Guide 1024.

## PHYSICAL PROPERTIES

COMPRESSIVE STRENGTH	17,300 psi (119.3 MPa)	ASTM D695 MOD*
COMPRESSIVE MODULUS OF ELASTICITY	800,000 psi (5515.8 MPa)	ASTM D695 MOD*
LINEAR SHRINKAGE	0.00018 in/in (0.00018 mm/mm)	ASTM D2566
COEFFICIENT OF LINEAR THERMAL EXPANSION	15.0 X 10 <sup>-6</sup> /°F @ 32°F to 140°F (27.0 x 10 <sup>-6</sup> /°C @ 0°C to 60°C)	ASTM D696
FLEXURAL STRENGTH	6,200 psi (42.8 MPa)	ASTM C580
FLEXURAL MODULUS OF ELASTICITY	1.4 x 10 <sup>6</sup> psi (9652.7 MPa)	ASTM C580
TENSILE STRENGTH	2,900 psi (20.0 MPa)	ASTM D638
SHEAR STRENGTH	5,000 psi (34.5 MPa)	FED-STD-406
IZOD IMPACT STRENGTH	5.1 in.lbs./in (0.23 N.m/cm)	ASTM D256
FIRE RESISTANCE	Self-Extinguishing	ASTM D635
SPECIFIC GRAVITY	1.94	
BARCOL HARDNESS	55 @ Full Cure	ASTM D2583

*The data shown reflect typical results based on laboratory testing under controlled conditions. Variations from the above data are typical for field-prepared samples.*

*\*Cured 24 hours at room temperature, post-cured 4 hours, and conditioned 4 hours at room temperature before evaluation.*

## PRODUCT INFORMATION

UNIT COVERAGE	265 in <sup>3</sup> (4,343 cm <sup>3</sup> )		
TYPICAL POUR DEPTH	1-¼" to 2-½" (32 - 62 mm)		
TYPICAL APPLICATION TEMPERATURES	55°F to 95°F (13°C to 35°C)		
INITIAL CURE TIME (APPROXIMATE, BASED ON CONTACT SURFACE TEMPERATURES)	60°F (15°C):	48 hours	
	65°F (18°C):	36 hours	
	70°F (21°C):	24 hours	
	80°F (27°C):	18 hours	
POT LIFE (APPROXIMATE)	70°F (21°C):	45 mins.	
PACKAGING PER UNIT	RESIN (A):	1.2 gal (4.5 L) in a 2-gal pail	
	HARDENER (B):	11.5 oz (0.34 L) in a 16-oz plastic bottle	
COMPONENT WEIGHTS	RESIN (A):	18.2 lbs. (8.3 kg)	
	HARDENER (B):	0.76 lbs. (0.35 kg)	
UNIT SHIPPING WEIGHT	21 lbs. (9.5 kg)		
COLOR	RESIN (A):	BLACK	
	HARDENER (B):	CLEAR TO AMBER	
	MIXED (A + B):	BLACK	
CLEAN UP	IMPAX IXT-59 Solvent or equal		
SHELF LIFE	2 years in dry storage		
CHEMICAL RESISTANCE	Refer to Technical Guide 675		

## REFERENCE

For any additional recommendations or applications beyond the typical ones listed in this document, please contact your local representative of our Worldwide Distributor Network or ITW Performance Polymers for further support.

**General:** Every reasonable effort is made to insure the technical information and recommendations on these data pages are true and accurate to the best of our knowledge at the date of issuance. However, this information is subject to change without notice. Prior versions of this publication are invalid with the release of this version. Products and information are intended for use by qualified applicators that have the required background, technical knowledge, and equipment to perform said tasks in a satisfactory manner. Consult your local distributor for product availability, additional product information, and technical support. **Warranty:** ITW Performance Polymers, a division of Illinois Tool Works Inc., warrants that its products meet their printed specifications. This is the sole warranty. This warranty expires one year after product shipment. **Warranty Claims:** If any product fails to meet the above, ITW Performance Polymers will, at its option, either replace the product or refund the purchase price. ITW Performance Polymers will have no other liability for breach of warranty, negligence, or otherwise. All warranty claims must be made in writing within one year of the date of shipment. No other claims will be considered. **Disclaimer:** ITW Performance Polymers makes no other warranty, expressed or implied, and specifically disclaims any warranty of merchantability or fitness for a particular purpose. Suggestions concerning the use of products are not warranties. The purchaser assumes the responsibility for determining suitability of products and appropriate use. ITW Performance Polymers' sole liability, for breach of warranty, negligence or otherwise, shall be the replacement of product or refund of the purchase price, at ITW Performance Polymers' election. Under no circumstances shall ITW Performance Polymers be liable for any indirect, incidental or consequential damages. **Modification of Warranty:** No distributor or sales representative has the authority to change the above provisions. No change in the above provisions will be valid unless in writing and signed by an officer or the Technical Director of ITW Performance Polymers. No term of any purchase order shall serve to modify any provision of this document. **Mediation and Arbitration:** If any dispute arises relating to products or product warranties, either the purchaser or ITW Performance Polymers may a) initiate mediation under the then current Center for Public Resources (CPR) Model Procedure for Mediation of Business Disputes, or b) initiate a non-binding arbitration under the rules of the American Arbitration Association for the resolution of commercial disputes.

## ITW PERFORMANCE POLYMERS

130 Commerce Drive | Montgomeryville | PA 18936 | USA | T: +1-215-855-8450 | E-mail: customerservice.na@itwpp.com | www.itwperformancepolymers.com  
Bay 150 | Shannon Industrial Estate | Shannon | County Clare | Ireland | T: +353 61 771 500 | E-mail: customerservice.shannon@itwpp.com